



GLEDOPTO

ZIGBEE MINI CONTROLLER User Instruction



(GL-MC-001PK)

Features:

Gateways/hubs Gledopto zigbee products Directly work with:
HUE, Amazon echo plus, SmartThings, Homee etc Via Hue gateway,
can work with google home, all other alexa devices

App work with Hue gateway:

Hue, hueparty, hue Disco, iConnectHue, Hue Widget, Light DJ, etc

Work with Home Assistant:

[https://www.reddit.com/r/Gledopto/com-
ments/ad9mbh/how_to_use_home_assistantha_to_control_gledopto/](https://www.reddit.com/r/Gledopto/comments/ad9mbh/how_to_use_home_assistantha_to_control_gledopto/)

Work with Homekit: (Not directly)

[https://www.reddit.com/r/Gledopto/com-
ments/amp3v9/i_wrote_a_little_guide_on_getting_the_gledopto/](https://www.reddit.com/r/Gledopto/comments/amp3v9/i_wrote_a_little_guide_on_getting_the_gledopto/)

Sync effect with screenbloom:

Sync your lights with movies, music, and games, Enjoy the lighting effect which
synchronizes with the plot of the picture immediately, and experience the more
delicate atmosphere lighting effect.

How to sync?

Gledopto HDMI SYNC Box
Please follow this website: <http://www.screenbloom.com/>
Sync Show Demo: https://youtube.com/zZtJMy_774

Q&A or more info, please go to: www.gledopto.com or email to
sales@gledopto.com, or https://www.reddit.com/r/GLEDOPTO_Support

Thanks for buying our products.

In this manual we will explain the connection of wires and the connection with a ZigBee Light
Link / Zigbee 3.0 Gateway.

These devices work with many ZigBee Light Link Gateways* like Philips Hue, Amazon echo
plus or SmartThings.

Installation:

1. Turn off the Power.
2. Plug in the controller.
3. Now you can connect it with the gateway.

Connection with Gateway:

1. Connect the LED product to the controller see section "wire connection".
2. Start the device searching on the ZigBee Light Link / Zigbee 3.0 Gateway, it could take
some time. If the Gateway does not find the device, plug power off/on or make a reset.
3. After finding the device, the light will turn green, then you can save it to the rooms/groups.
4. Now you can use the device.

Reset:

1. Switch on your device,
2. Now switch off within 2 seconds.
3. Wait for more than 5 seconds.
4. Repeat off/on five times.
5. Reset is done when the device is switched on in the fifth time and the LED light will
be fully bright and flashing for 4 times.

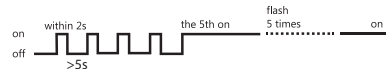

Please check the Compability Chart showing what gateways and
how our products work with, this chart just shows the gateways we
test, we will keep updating it. Welcome to check with our sales
and website.

Technical data:

Size: 11x22x43mm
Input Voltage: DC5V
Output Current/Channel: 2A max
Protection rate: IP20

Total Output Current: 2A max
Operating Temperature: -20°C ~ 55°C
Common Anode
Constant Voltage

Controller connection

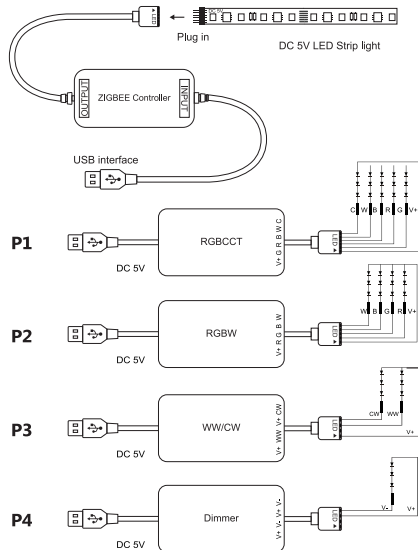

Connector usage

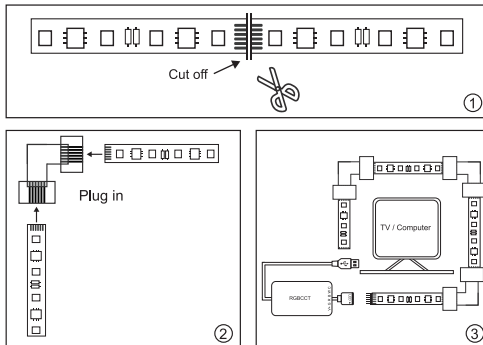

- ① Cut the LED strip light along the cutting line;
- ② Insert the cut LED strip light into the connector;
- ③ Now you can enjoy your smart lighting life.

Usage scenarios

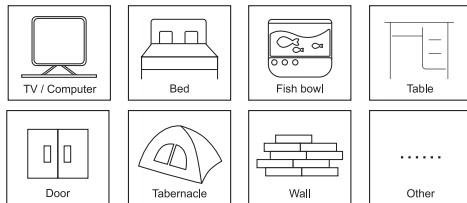

Compability Chart

Gateways	Philips Hue	Amazon Echo Plus	Smart Things	Tuya	Conbee	Homey	Homee
Item	①	②	③	④	⑤	⑥	⑦
RGB	Yes	Yes	Yes	Yes	Yes	Yes	Yes
CCT	Yes	Yes	Yes	Yes	Yes	Yes	NO
BRIGHTNESS	Yes	Yes	Yes	Yes	Yes	Yes	Yes

①②③④⑤⑥ are already tested by GLEDOPTO, ⑦ are from our customers, just for your information, not verified by GLEDOPTO.



LED-Trading Tobias Ebert
Schoeneicher Str. 42, Schoeneiche b. Berlin, Germany, 15566
0049 30 641 689 17 info@led-trading.de